

MACHINE SCREW & THREAD PATCH

INSTALLATION FOR ASSEMBLY WITH ITS COUNTERPARTS

Machine screws, also sometimes referred to as machine bolts, usually can come in larger variations. Typically machine screws are designed to be fastened to an existing tapped hole on a metal surface, usually in conjunction with a mating nut. Still, some machine screws have tapping ability to cut and thread a hole as they're inserted.

Thread Patch is permanently fused onto the screw thread of the fastener and increases the prevailing removal torque by acting as a wedge, allowing the screw to be locked physically or chemically in any position upon assembly.

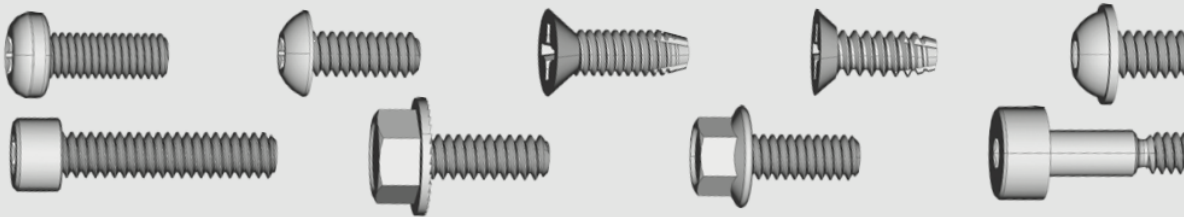

Features

- Available in a variety of drive types and heads, and fit a wide variety of applications.
- Carriage Bolt has the square section under the head grips into the part being fastened preventing the bolt from turning when the nut is tightened.
- Shoulder bolts are machine screws with a shoulder between the thread of the screw and the head of the part.
- Socket cap screws are in button socket, button flange socket head, flat socket and socket cap.
- Thread Patches include NYLOK[®], 3M Scotch Grip, and PRECOTE[®].

Category: Machine Screw

Size: M2.0mm~M10.0mm

Length: 6mm~100mm

Material: Carbon Steel/ Stainless Steel

Thread Type: Fine Thread, Coarse Thread

Point Type: Chamfer Point, Dog Point, Cone Point, Cup Point

Plating: Galvanized

Head Type: Pan, Flat, Cylinder, Hex, Round Washer

